

UNIVERSITY OF SOUTHERN INDIANA

Campus Legend

- Applied Engineering Center **AE**
- Arts Center **AC**
- Art Studio **AS**
- Bent Twig Outdoor Education Center **BT**
- 1. Amphitheatre
- 2. Bokelman #3 School
- 3. Breckinridge Cabin
- 4. Eicher Barn
- 5. Grimes Haus
- 6. Herb Garden
- 7. Restrooms
- 8. Westwood Lodge
- Business and Engineering Center **BE**
- Carter Hall (UC West 233) **UC**
- Children's Learning Center **CLC**
- Couchy/Renner Hall (ED 1101) **ED**
- Dowhie Ceramics Center **CC**
- Education Center **ED**
- Forum Lecture Halls (FA 1, 2, and 3) **FA**
- Forum Wing **FA**
- USI Foundation **FO**
- Griffin Center **GC**
- Grounds Maintenance Center **GM**
- Hamilton Music Studio (LA 0114) **LA**
- Health Professions Center **HP**
- I.U. School of Medicine—Evansville (HP 3026) **HP**
- Kleymeyer Hall (LA 0101) **LA**
- Liberal Arts Center **LA**
- Mallette Studio Theatre (LA 0105) **LA**
- McCutchan Art Center/Pace Galleries (LA 0155) **LA**
- Mitchell Auditorium (HP 1002) **HP**
- Orr Center **OC**
- Performance Center **PF**
- Physical Activities Center (PAC) **PA**
- Physical Plant Service Center **PP**
- Public Safety Building **PS**
- Publishing Services Center **PUB**
- Recreation, Fitness and Wellness Center **FC**
- Rice Library **RL**
- Science Center **SC**
- Support Services Center **SS**
- Theatre Support Center **TS**
- University Center **UC**
- A. UC Courtyard
- B. Rice Plaza
- C. The Cone
- D. UC Fountain
- E. Performance Center Courtyard
- Wright Administration Building **WA**
- Under Construction **EA**
- Fuquay Welcome Center **FWC**
- Screaming Eagle Arena **EA**

- Pedestrian, Bike and Nature Trail
- Blue Emergency Phone
- Bus Stop

The off-campus recreational and varsity softball fields can be reached by traveling south on Schutte Road, then west on Broadway 1/4 mile; see map inset.

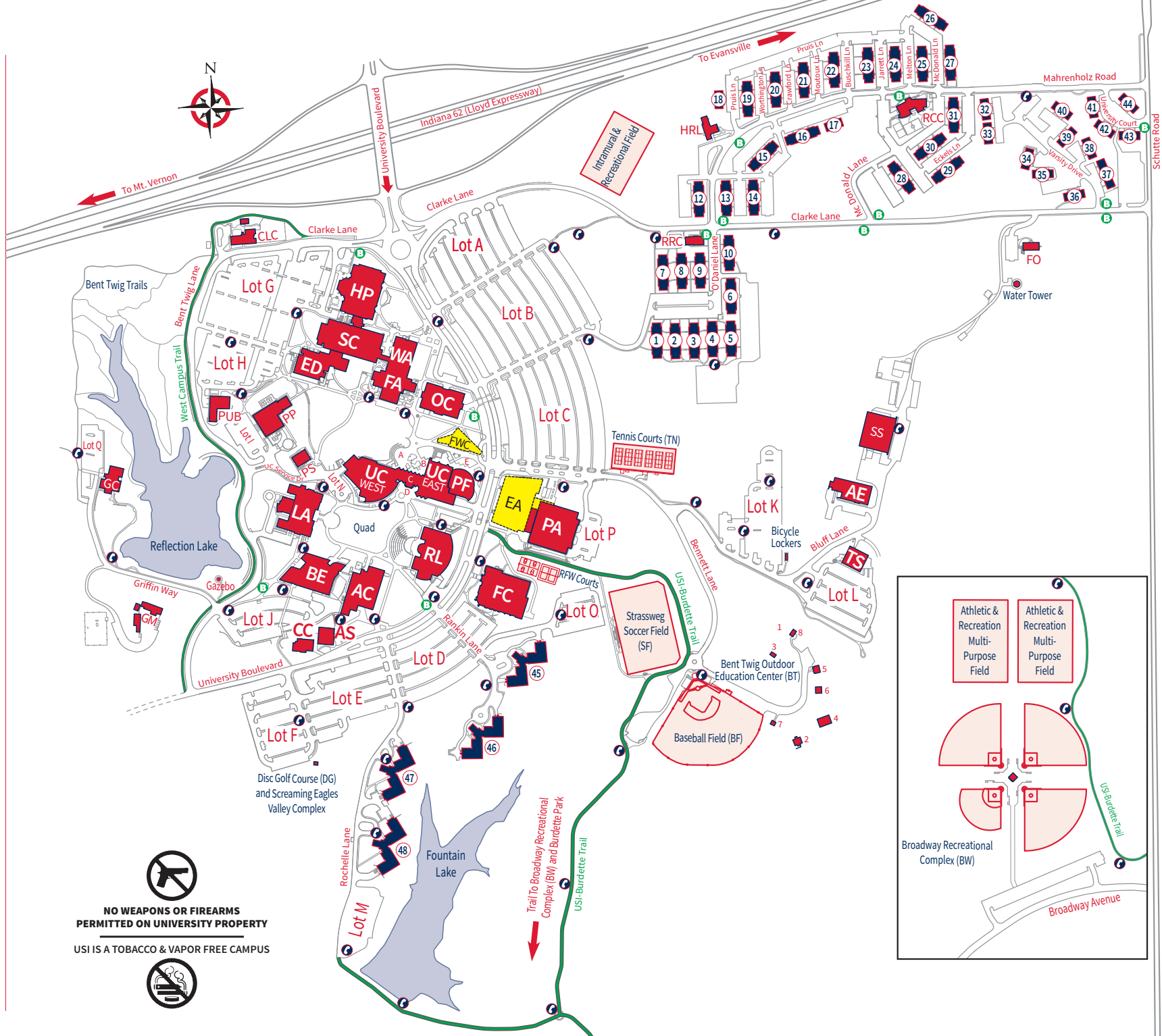

NO WEAPONS OR FIREARMS PERMITTED ON UNIVERSITY PROPERTY

USI IS A TOBACCO & VAPOR FREE CAMPUS

Housing Legend

- Housing and Residence Life Center **HRL**
- Residence Life Community Center **RCC**
- Residence Life Resource Center **RRC**
- Baker Building—McDonald East **32**
- Bayh Building—O'Daniel North **22**
- Bigger Building—O'Daniel South **1**
- Boon Building—O'Daniel South **6**
- Bowen Building—O'Daniel North **20**
- Branch Building—McDonald West **26**
- Branigin Building—O'Daniel North **13**
- Chase Building—McDonald East **42**
- Craig Building—O'Daniel North **19**
- Dunning Building—O'Daniel South **8**
- Durbin Building—McDonald West **31**
- Gates Building—O'Daniel North **18**
- Gray Building—McDonald East **35**
- Goodrich Building—McDonald West **25**
- Governors Hall **46**
- Hammond Building—McDonald East **38**
- Hanly Building—McDonald West **30**
- Hendricks Building—O'Daniel South **5**
- Hendricks Building—McDonald East **33**
- Hovey Building—McDonald East **43**
- Jackson Building—McDonald West **23**
- Jennings Building—O'Daniel South **10**
- Lane Building—McDonald East **39**
- Leslie Building—O'Daniel North **16**
- Marshall Building—McDonald West **28**
- Matthews Building—McDonald East **41**
- McCray Building—McDonald West **24**
- McNutt Building—O'Daniel North **15**
- Morton Building—McDonald East **40**
- Mount Building—McDonald East **44**
- Newman Hall **45**
- Noble Building—O'Daniel South **3**
- O'Bannon Hall **47**
- Orr Building—O'Daniel North **21**
- Porter Building—McDonald East **36**
- Ralston Building—McDonald West **27**
- Ray Building—O'Daniel South **4**
- Ruston Hall **48**
- Saletta Building—McDonald West **29**
- Schricker Building—O'Daniel North **12**
- Townsend Building—O'Daniel North **14**
- Wallace Building—O'Daniel South **2**
- Welsh Building—O'Daniel North **17**
- Whitcomb Building—O'Daniel South **7**
- Willard Building—McDonald East **37**
- Williams Building—McDonald East **34**
- Wright Building—O'Daniel South **9**

